

RMAX THERMASHEATH-SI – A LAYERED APPROACH TO SAVING

Maximize profits through value engineering. That's what Thermasheath[®]-SI provides. Thermasheath-SI is a revolutionary new structural insulated sheathing from Rmax[®]. The key is in the layers. Thermasheath-SI combines a layer of structural stability with superior continuous insulation, an air barrier, and a water barrier. The result is a product that raises the bar on how sheathing is measured.

Thermasheath-SI provides a continuous structural insulation across your entire wall to optimize design. Compared to OSB, this lightweight building product reduces time and cost in materials and labor. As continuous insulation, it is also the most effective way to insulate the envelope, reducing energy consumption and greenhouse gasses.

It Makes Sense

Why wrap the house more than needed? By combining a structural panel with an air barrier, a water barrier, and a continuous insulation, Thermasheath-SI puts the power of multiple building products into a single application. Therefore, you reduce labor/installation costs, while raising R-values, structural capacity, and resistance to moisture and air infiltration. Doesn't that make sense?

It Saves Costs

It's easy to see how Thermasheath-SI from Rmax saves money during construction - it cuts down on the number of materials and trips around the house. It also saves money for homeowners with lower energy consumption through thermal efficiency. Don't home owners want to save money month after month?

It Maximizes Profit

Combining Thermasheath-3 in the field, with Thermasheath-SI as intermittent braced wall panels, provides a total home sheathing solution. With a single application, builders can cut time and labor costs while maximizing margins; all in a code compliant package. Don't you want to improve your bottom line?

The Secret is in the Layers

Structural - Made up of 97% recycled content, the fiberboard layer is a lightweight, rigid structural layer designed for lateral bracing and transverse loads, including portal frames and seismic design.

Insulation - A high R-value Polyiso layer that provides continuous insulation and meets the highest energy-efficient standards.

Air and Water Barrier - An impermeable foil facing that repels water and guards against air infiltration.

4-IN-1 APPROACH: ONE BUILDING PRODUCT TO COMPLETE THE ENVELOPE

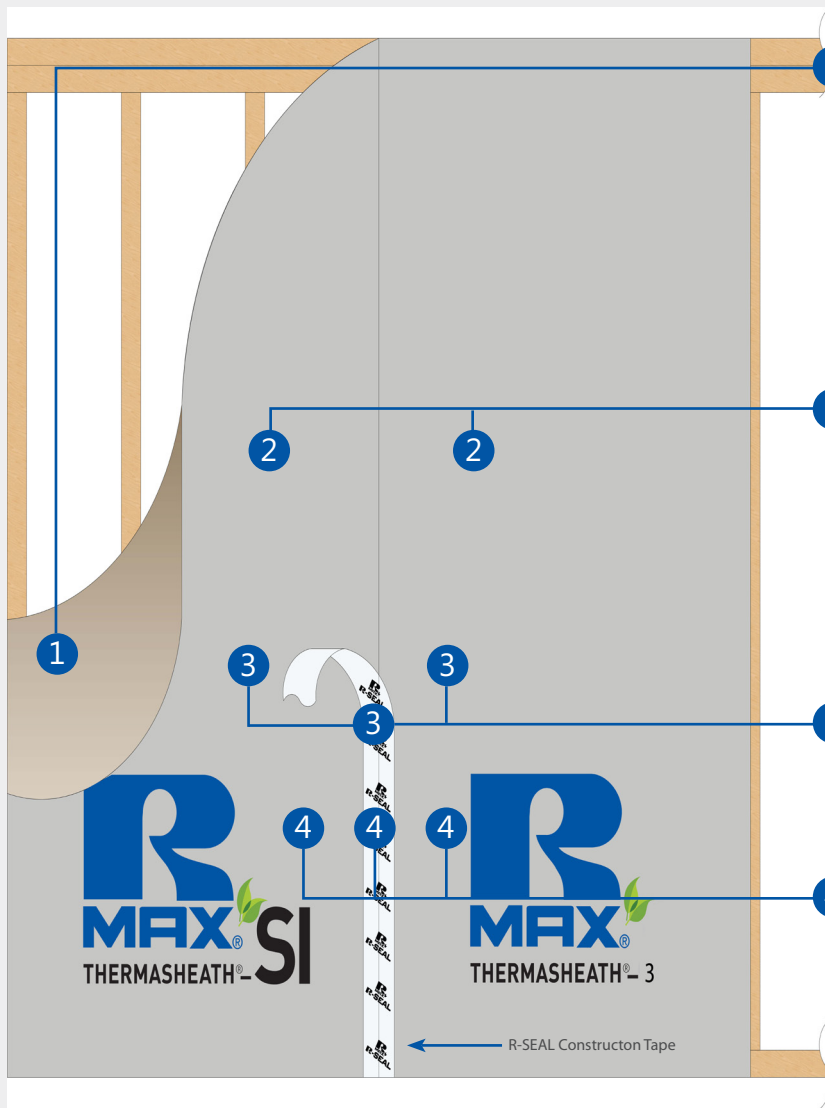

- 1 Structural Bracing**
 - Install continuously across the wall to simplify design
 - Install as a braced wall panel with Thermasheath-3 to optimize design costs
 - Eliminates the need for heavy OSB sheathing
 - Decrease time and costs associated with materials and labor
- 2 Continuous Insulation (c.i.)**
 - Polyiso has the highest R/inch of any foam plastic insulation
 - Eliminates thermal bridging
 - Allows you to meet or exceed energy code requirements
 - Lowers energy consumption and energy bills
- 3 Air Barrier**
 - Prevent air infiltration
 - Keeps the home comfortable
 - Makes your HVAC systems run more efficient
- 4 Water-Resistive Barrier (WRB)**
 - Eliminates the need for house wrap or felt
 - Resists water intrusion and moisture migration
 - Defends against the growth of mold and mildew

Corporate & Technical Location

Rmax Operating, LLC
Dallas, Texas
(800) 527-0890

Customer Service & Plant Locations

Central Region Dallas, Texas (800) 527-0890 Ext. 102	Eastern Region Greer, South Carolina (800) 845-4455 Ext. 156	Western Region Fernley, Nevada (800) 762-9462 Ext. 156
--	--	--

