



PermaBG

PermaBG and PermaBG+ INSECT/TERMITE RESISTANT FOAM INSULATION Suitable for Below and Above Grade Applications

PermaBG EPS Insulation has the compressive strength and the moisture resistance for unequalled long term performance in demanding below-grade applications such as sub-slab and perimeter foundations.

PermaBG is resistant to common soil acids and decay and is easily installed with spot adhesives, fasteners or wall ties.

PermaBG has no thermal drift, increasing thermal performance in cavity wall applications while reducing basement heating requirements. It is available in several compressive strengths to withstand load and backfill forces.

PermaBG+ offers a heat laminated tough poly facer to both sides of the EPS core for added strength and durability in storing, handling and installation.

Required Compressive Strength	PermaBG PermaBG+ (min. pcf)	R-Value per inch	Comparable XPS
10psi	Type I (0.90)	3.85	None
15psi	Type II (1.35)	4.20	Type X
25psi	Type IX (1.80)	4.35	Type IV
40psi	Type XIV (2.40)	4.40	Type VI
60psi	Type XV (3.00)	4.50	Type VII

Benefits

- ✓ *Field-tested and code-approved termite resistance*
- ✓ *Permanent R-Value*
- ✓ *Non-hygroscopic, water resistant closed cell-structure*
- ✓ *No formaldehyde, CFCs, HCFCs or other volatile contents*
- ✓ *Installs the same as XPS insulation*

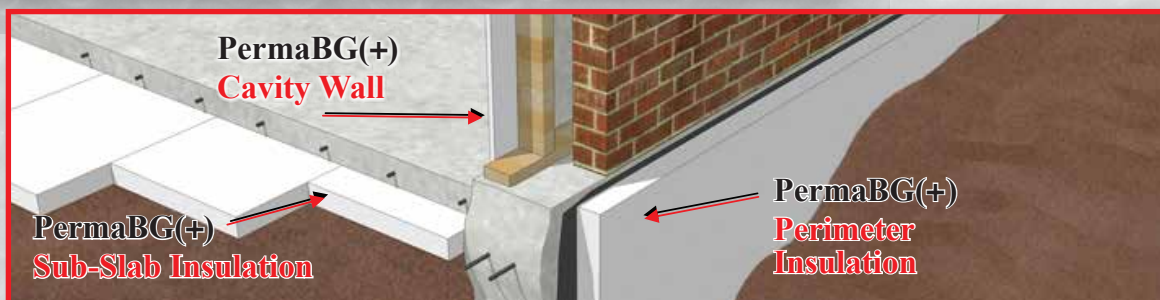

Codes and Compliances

UL Listed—R7260 • ASTM-C578

Meets HUD/FHA Use of Materials Bulletin No. 71A

Federal Specification HA-1-1972 • ICC-ES report ESR-1820 and ESR-2918

CAUTION: This product is combustible and if exposed to a fire of sufficient heat and intensity may burn rapidly. It should not be left exposed or inadequately protected. Consult specific instructions for use accompanying this product.

PermaBG and PermaBG+

Environmental Benefits

	Inches* to Achieve R-10	Inert & Stable	Job Site Reclamation	Post Ind. Waste Used	Post Cons. Waste Used	Insect/Termite Resistant
Extruded (XPS) All Densities	2.00"	YES	NO	NO	NO	NO
PermaBG Type I	2.60"	YES	YES	YES	YES	YES
PermaBG Type II	2.40"	YES	YES	YES	YES	YES
PermaBG Type IX	2.30"	YES	YES	YES	YES	YES
PermaBG Type XIV	2.25"	YES	YES	YES	YES	YES
PermaBG Type XV	2.20"	YES	YES	YES	YES	YES

* $\pm 1/16"$ (0.0625")

AVAILABLE SIZES

(Square Edge Only):

Thickness	<u>ANY</u> up to 36 Inches
Width	<u>ANY</u> up to 4 Feet
Length	<u>ANY</u> up to 18 Feet

BUNDLE SIZES:

1" Thickness	22pcs/Bundle
1½" Thickness	15pcs/Bundle
2" Thickness	11pcs/Bundle
R-10 Thickness	Custom Bundle Sizes

*After lab testing
you can see how
Preventol not only
killed the termites,
it also caused a
lighter attack than
the borate based
counterpart.*

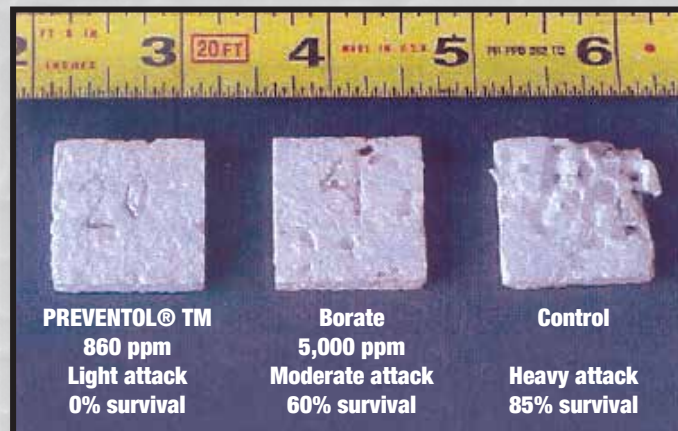

Photo: Comparison of EPS in AWP A E1 two choice test (4 week exposure) (L-R): **PREVENTOL® TM Preservative Insecticide**, borate, and untreated.



cellofoam®

EPS MANUFACTURER SINCE 1966

ORLANDO, FL

11237 Astronaut Blvd 32837
(800) 423-3626
FAX (407) 888-9464

www.cellofoam.com

CONYERS, GA

1917 Rockdale Industrial Blvd. 30012
(800) 944-8704
FAX (770) 483-8912

FREDERICKSBURG, VA

16 Baron Park Road 22405
(800) 288-7663
FAX (540) 373-6738

WHELAND, IN

150 Crossroads Drive 46184
(800) 582-9007
FAX (317) 535-5211

SALLISAW, OK

400 E. Houser Ave. 74955
(800) 864-1518
FAX (918) 775-2870